

LED

490
ICON



Unique fixture provides a halo of light on the back plate for a very interesting look. The compact design allows the fixture to be used in hallways or along side of mirrors. Optional stainless steel finish is ideal for modern environments.

Indessa
LIGHTING

490 ICON

LED

TYPE

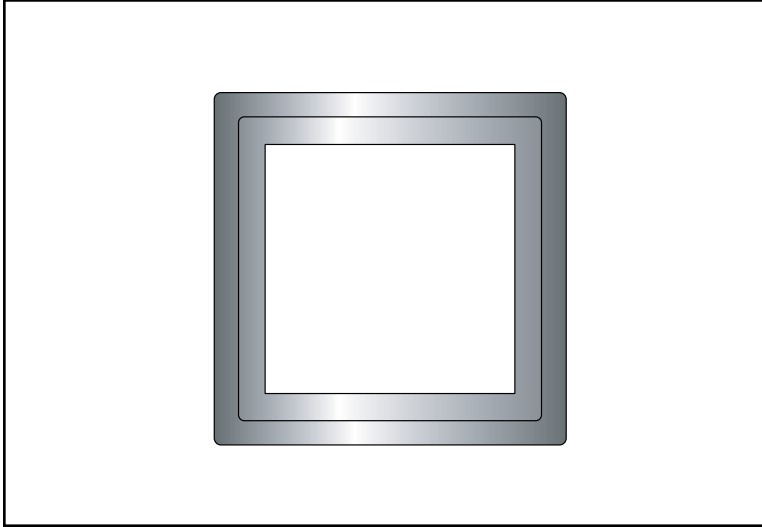

PROJECT: _____

LOCATION: _____

FEATURES

- Compact fixture provides an ample amount of illumination.
- Secondary frame around lens provides double layer halo effect.
- Sand blasted acrylic softens lamp image.
- All acrylic is mechanically attached for long lasting retention.
- Complies with ADA.
- Standard Triac / ELV dimming driver.
- No visible fasteners.
- Manufactured in the U.S.A.

DIMENSIONS

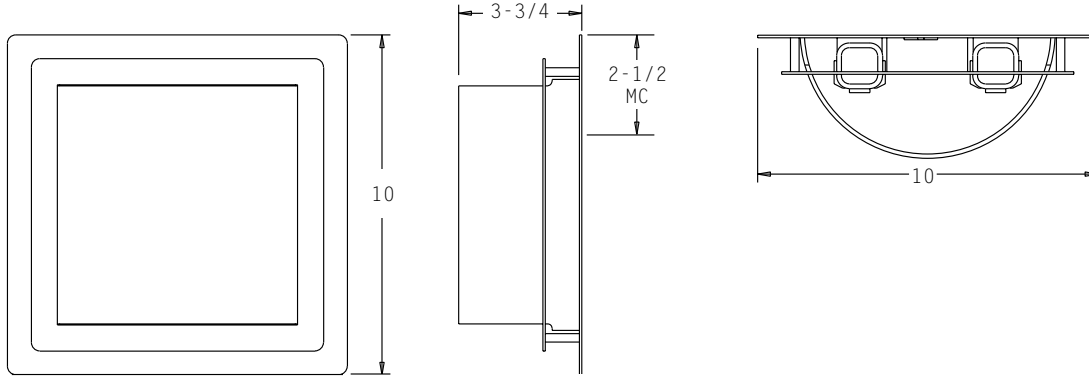

MC = Mounting Center

A 4" octagonal junction box should be used for installation.

ORDERING INFORMATION / OPTIONS EXAMPLE: 490-1LED10-BLK

490

MODEL

490 - Icon

LAMP

- 1LED10** - (1) 10W LED Module 1000 Lumens
- 1CFQ13** - (1) 13w QUAD TUBE CF (G24Q-1 Base)
- 1CFQ18** - (1) 18w QUAD TUBE CF (G24Q-2 Base)
- 2CFQ13** - (2) 13w QUAD TUBE CF (G24Q-1 Base)
- 2CFQ18** - (2) 18w QUAD TUBE CF (G24Q-2 Base)
- 2CFQ26** - (2) 26w QUAD TUBE CF (G24Q-3 Base)

HOUSING FINISH

- WHT** - White
 - BLK** - Black
 - SAL** - Silver
 - BRZ** - Bronze
 - SS** - Stainless Steel
- Consult factory for other finishes.*

OPTIONS

- DL** - Damp Label
- Lamp** - Lamp provided, please specify color temperature
- 30K** - 3000 Kelvin Temperature
- 35K** - 3500 Kelvin Temperature
- 40K** - 4000 Kelvin Temperature