

484  
SEDONA



A Faux Alabaster lens attached to a distinctive, rigid frame gives this luminaire a warm yet stylish appeal. Ideal for offices, schools or churches, Sedona mounts flush to the wall on both sides while still providing ample illumination.

# 484 SEDONA

TYPE

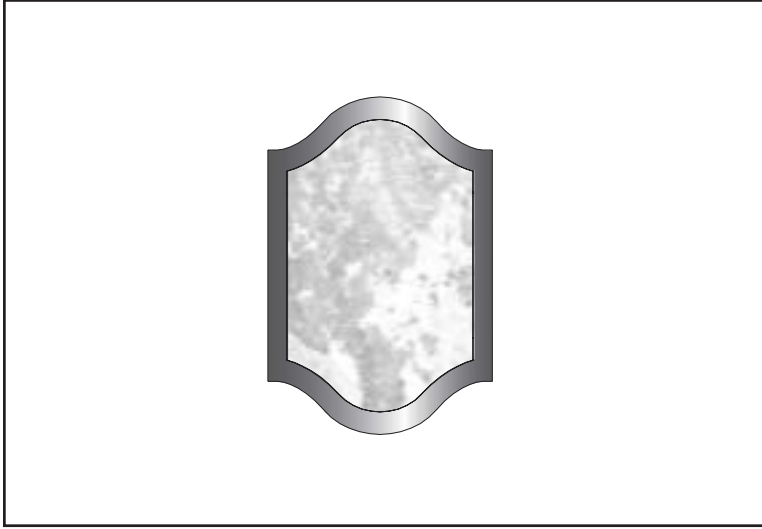

PROJECT: \_\_\_\_\_

LOCATION: \_\_\_\_\_

## FEATURES

- An auburn tinted Faux Alabaster lens provides warmth and style to the fixture.
- Contoured lens increases uniformity and eliminates “hot spots”.
- Unitized design allows the fixture to be used in even the most restrictive budgets.
- A wide choice of lamps can provide varying amounts of illumination.
- Flush mounting on the side of the fixture provides complete side shielding.
- Electronic multi-volt (120/277) ballast is standard.
- Meets all ADA requirements.
- Manufactured in the USA.

## DIMENSIONS

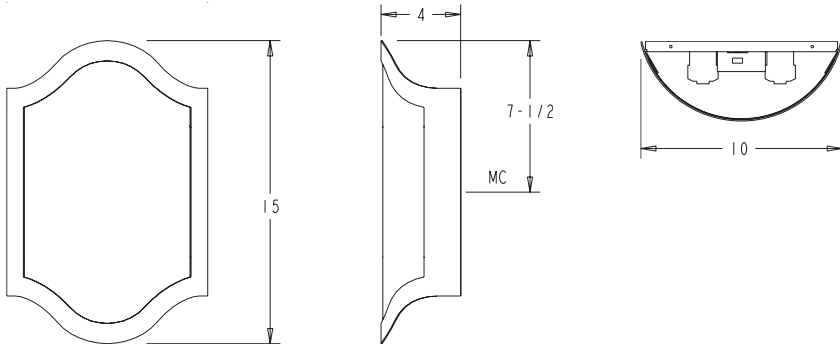

## ORDERING INFORMATION / OPTIONS EXAMPLE: 484-2CFQ26-BRZ

# 484

### MODEL

484 - Sedona

### LAMP

**1CFQ13** - (1) 13W QUAD TUBE CF (G24Q-1 BASE)  
**1CFQ18** - (1) 18W QUAD TUBE CF (G24Q-2 BASE)  
**1CFQ26** - (1) 26W QUAD TUBE CF (G24Q-3 BASE)  
**1CFT26** - (1) 26W TRIPLE TUBE CF (GX24Q-3 BASE)  
**1CFT32** - (1) 32W TRIPLE TUBE CF (GX24Q-3 BASE)  
**1CFT42** - (1) 42W TRIPLE TUBE CF (GX24Q-4 BASE)  
**2CFQ13** - (2) 13W QUAD TUBE CF (G24Q-1 BASE)  
**2CFQ18** - (2) 18W QUAD TUBE CF (G24Q-2 BASE)  
**2CFQ26** - (2) 26W QUAD TUBE CF (G24Q-3 BASE)  
**2CFT26** - (2) 26W TRIPLE TUBE CF (GX24Q-3 BASE)

Consult factory for other available lamps.

### HOUSING FINISH

**WHT** - White  
**BLK** - Black  
**SAL** - Silver  
**BRZ** - Bronze  
 Consult factory for other finishes.

### OPTIONS

**DL** - Damp label  
**Lamp** - Lamp provided, please specify color temperature  
**LWhite** - White Opal Acrylic Lens

# Indessa

Lighting

3808 N SULLIVAN RD, BLDG 12, STE 5 • SPOKANE, WA • 99216  
 PHONE: 509.924.0243 • FAX: 509.924.2607 • www.indessa.com



Indessa Lighting reserves the right to make design revisions without prior notice.

IW-14